



**PLAFON 2xE27  
C/SENSOR HF  
BLANCO**



2xE27	MÁX. 2x20W	5.8 GHz	IP66	SENSIBILIDAD 2-2000 LUX
-------	---------------	------------	------	-------------------------------

**ref.DOW-095**

PLAFÓN CON SENSOR  
ALTA FRECUENCIA 5.8GHz  
2xE27  
MÁX. 2x20W LED  
ÁNGULO: 360°  
DETECCIÓN: 2-10 METROS  
SENSIBILIDAD: 2-2000 LUX  
TIEMPO ENCENDIDO: 8 SEG - 12 MIN  
AC 230V  
50/60 Hz

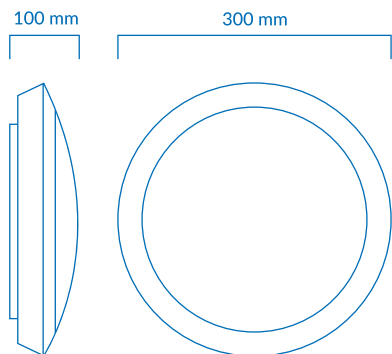

DISTANCIA DE DETECCIÓN	TIEMPO DE ENCENDIDO	LUMINOSIDAD
2-10 m	8 seg - 10 min	2-2000 LUX



1

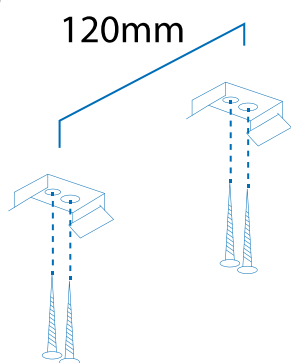

1. Fijar los perfiles omega a una distancia de 120mm entre agujeros.

2

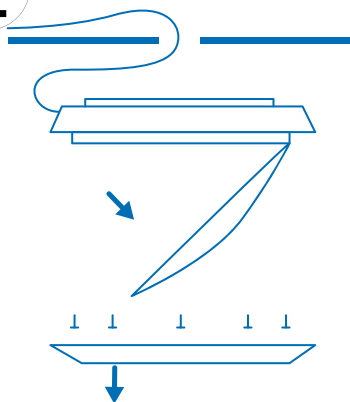

2. Retirar el aro, la tapa y conectar a la corriente.

3

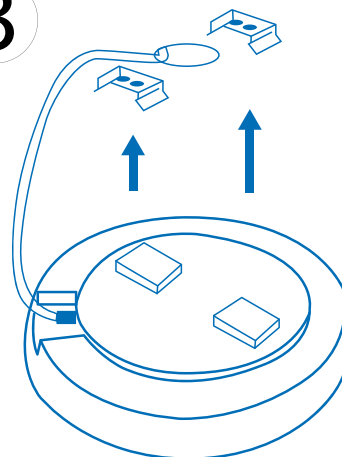

3. Encajar el plafón en los perfiles omega.

ATMOSS ELECTRIC EQUIPMENT S.L.  
c/ Mecánicos, 5, Pol. Ind. 2  
03130, Santa Pola (Alicante)  
ESPAÑA



## DECLARACIÓN CE DE CONFORMIDAD

Referencia del producto: DOW-198, DOW-199, DOW-200, DOW-201, DOW-202, DOW-203, DOW-204, DOW-205, DOW-206, DOW-207, DOW-208, DOW-209, DOW-210, DOW-211, DOW-212, DOW-213, DOW-194, DOW-195, DOW-236, DOW-191, DOW-192, DOW-193, DOW-214, DOW-215, DOW-216, DOW-158, DOW-157, DOW-095, DOW-237, DOW-238, DOW-239, DOW-240, DOW-241, DOW-242, DOW-243, DOW-244, DOW-245, DOW-246, DOW-247, DOW-248, DOW-249, DOW-250, DOW-251, DOW-161, DOW-156, DOW-151, DOW-183, DOW-184, DOW-185, DOW-278, DOW-279, DOW-280, DOW-281

ATMOSS ELECTRIC EQUIPMENT S.L. declara que el producto mencionado ha sido fabricado de acuerdo con las directivas europeas que se citan a través del cumplimiento de las siguientes normas.:

Nº	Directiva
2006/95/EC	Equipo eléctrico para ser utilizado dentro de unos valores de tensión limitados. Directiva de baja tensión.

Normas: UNE-EN 60598-1:09+A1:11:19

Nº	Directiva
2004/108/EC	Compatibilidad Electromagnética. Directiva EMC.

Normas: UNE-EN 55015: 2013; UNE-EN 6100-3-2: 2006 + A1: 2009 + A2: 2009; UNE-EN 6100-3-3: 2013; UNE-EN 61547: 2009

Marcelo Ferri Sanchis  
Gerente

25 de Enero de 2021



# CERTIFICATE

of Conformity

Reference No.: AT03142576S

**Applicant** : ATMOSS ELECTRIC EQUIPMENT S.L.

**Address** : CALLE MECANICOS 5, 03130, SANTA POLA (ALICANTE)

**Product** : LED PANEL LIGHT

**Model(s)** : DOW-198, DOW-199, DOW-200, DOW-201, DOW-202, DOW-203, DOW-204, DOW-205, DOW-206, DOW-207, DOW-208, DOW-209, DOW-210, DOW-211, DOW-212, DOW-213, DOW-194, DOW-195, DOW-236, DOW-191, DOW-192, DOW-193, DOW-214, DOW-215, DOW-216, DOW-158, DOW-157, DOW-095, DOW-237, DOW-238, DOW-239, DOW-240, DOW-241, DOW-242, DOW-243, DOW-244, DOW-245, DOW-246, DOW-247, DOW-248, DOW-249, DOW-250, DOW-251, DOW-161, DOW-156, DOW-151, DOW-183, DOW-184, DOW-185, DOW-278, DOW-279, DOW-280, DOW-281

**Trade mark** : N/A

The submitted products have been tested by us with the listed standards and found in compliance with the following European Directives:

**The EMC Directive 2004/104/EC**

**EN 55015: 2006+A1+A2 2009;**

**EN 61547: 2009**

**EN 61000-3-2: 2006+A1: 2009+A2: 2009**

**EN 61000-3-3: 2013**

The tests were performed in normal operation mode. The test results apply only to the particular sample tested and to the specific tests carried out.

This certificate applies specifically to the sample investigated in our test reference number only.

The CE markings as shown below can be affixed on the product after preparation of necessary technical documentation.

Other relevant Directives have to be observed.



January 25, 2021

Shenzhen LCS Compliance Testing Laboratory Ltd.  
 1/F., Xingyuan Industrial Park, Tongda Road, Bao'an Avenue, Bao'an District,  
 Shenzhen, Guangdong, China  
 Tel: (86)755-82591330 Fax: (86)755-82591332  
 Http://www.LCS-cert.com Email: webmaster@LCS-cert.com