

## 18W 480MM SMART DC CEILING FAN BLADELESS WITH WIFI REMOTE CONTROL + LED LIGHT



### Model Numbers

MFDC480W Matt White



Scan for  
product  
information

### Features

- Brushless quiet and efficient 18W DC motor
- WiFi connectivity and operate via Smart Life application
- Low ceiling and slimline designed ideal for indoor and covered outdoor applications
- Unique comfort sleep and breeze mode + 6 other speed settings
- ABS body with a polycarbonate lens cover
- Fully reversible for summer and winter mode from remote control
- 35W LED with variable dimming
- Variable 6 stage colour temperature between 2700K to 6000K

## 18W 480MM SMART DC CEILING FAN BLADELESS WITH WIFI REMOTE CONTROL + LED LIGHT

### SPECIFICATIONS

<b>Model Name</b>	Fantom DC
<b>Model Numbers</b>	MFDC480W Matt White
<b>Power Wattage / Motor</b>	18W DC
<b>Voltage / Frequency</b>	220-240Va.c. 50-60Hz
<b>Air Movement (m<sup>3</sup>/hr)</b>	
<b>Maximum RPM</b>	Up to 500 RPM
<b>Airflow Efficiency</b>	Up to 195m <sup>3</sup> /hr per watt
<b>Turbo Speed</b>	4,500m <sup>3</sup> /hr
<b>Speed 6 (Highest)</b>	3,900m <sup>3</sup> /hr
<b>Speed 5</b>	3,000m <sup>3</sup> /hr
<b>Speed 4</b>	2,400m <sup>3</sup> /hr
<b>Speed 3</b>	1,700m <sup>3</sup> /hr
<b>Speed 2</b>	1,500m <sup>3</sup> /hr
<b>Speed 1 (Lowest)</b>	1,100m <sup>3</sup> /hr
<b>Materials / Blade</b>	N/A
<b>Number of Blades</b>	0
<b>Blade Pitch</b>	N/A
<b>Hangsure Canopy</b>	N/A
<b>Lighting Wattage / Type</b>	35W LED
<b>Colour Temperature</b>	2700K to 6000K
<b>Lumens Output</b>	Up to 2753lm
<b>Rated Lifetime</b>	50,000 hours @ Ta25°C
<b>Dimmable</b>	Variable dimming

### REMOTE CONTROL

<b>Control</b>	
<b>Light</b>	On/off
<b>CCT</b>	2700K/3000K/4000K/5000K/6000K
<b>Fan</b>	Off only
<b>Fan Speed Setting</b>	6
<b>Other Features</b>	Summer/winter reverse mode Breeze mode Sleep mode
<b>Timer</b>	Off only - 1hr, 4hr or 8hr
<b>Power</b>	1 x A23 12V batteries (supplied)
<b>Size</b>	145 x 42mm
<b>Radio Frequency</b>	433Mhz

### SHIPPING

Model Numbers	Carton Size			Carton Quantity	Carton Gross Weight (Kg)
	H (mm)	W (mm)	L (mm)		
MFDC480W	530	530	250	1	6.5

### INSTALLATION

<b>Installation</b>	By licensed electrician only	
<b>Warranty</b>	6* year warranty (*3 year in-home + additional 3 year replacement on the motor only)	
	For further information please visit our website OR scan the QR Code <a href="https://www.martecaustralia.com.au/warranty-statement/">https://www.martecaustralia.com.au/warranty-statement/</a>	

### DIMENSIONS

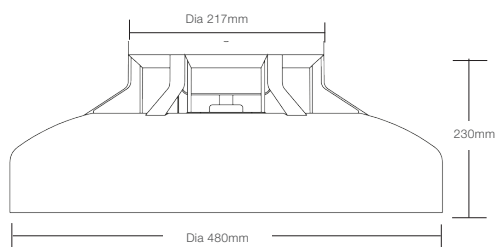

\* Product must be installed by licensed electrician if not warranty will be void.  
Specification and imagery subject to change without prior notice. Last updated October 2024.



Aust/NZ Approval No.